

### 2070 FRAME & COVER

Heavy duty  
 Vertical and horizontal machined surfaces  
 Unit assembled with 4 – 5/8" SS bolts and  
 1/4" flat gasket  
 Watertite assembly

Options  
 Special lettered covers

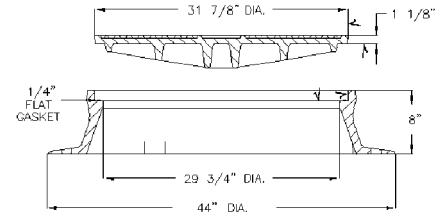

### 2075 FRAME & COVER

Heavy duty  
 Vertical and horizontal machined surfaces  
 Unit assembled with 5 – 5/8" SS bolts and  
 1/4" flat gasket  
 Watertite assembly

Options  
 Special lettered covers

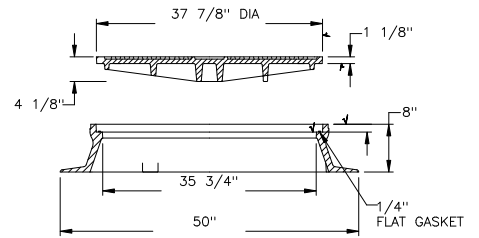

### 2080 FRAME & COVER

Heavy duty  
 Machined bearing surfaces

Options  
 Solid or vented covers  
 Special lettered covers  
 Gasket seal cover

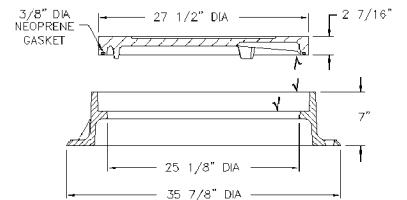

Supplied By:



877-903-7246

www.trenchdrainsupply.com

